

THE SCHEME WAS DISCUSSED IN THE 27th SCREENING COMMITTEE MEETING HELD ON 24.10.08 VIDE ITEM NO. 158.2008. THE PROPOSAL AS REFLECTED IN THE AGENDA HAS BEEN APPROVED, SUBJECT TO * THE LOCATION OF PRIMARY SCHOOL AND THE COMM. HALL BE INTERCHANGED.

Manjit 26/11/08

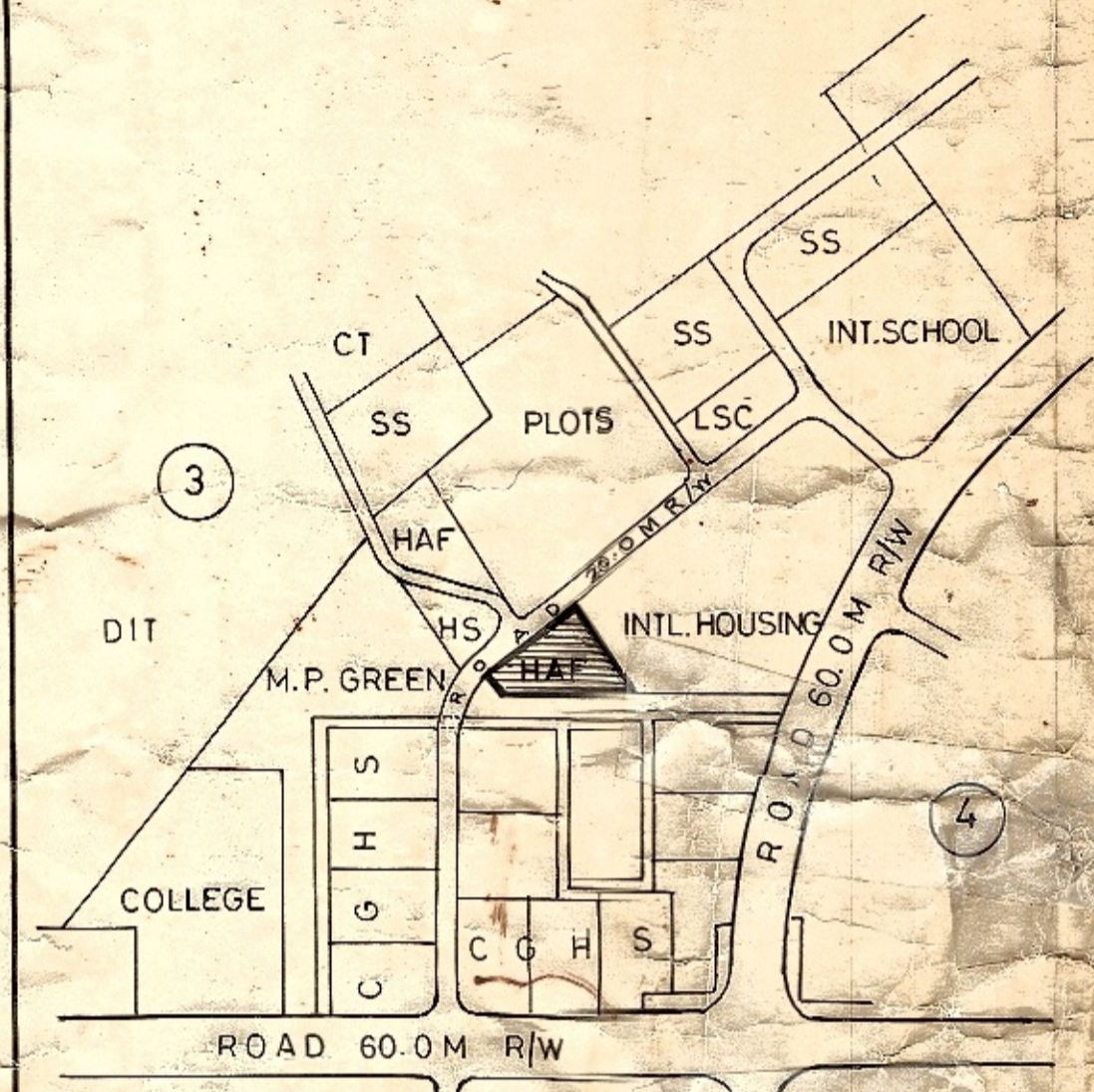
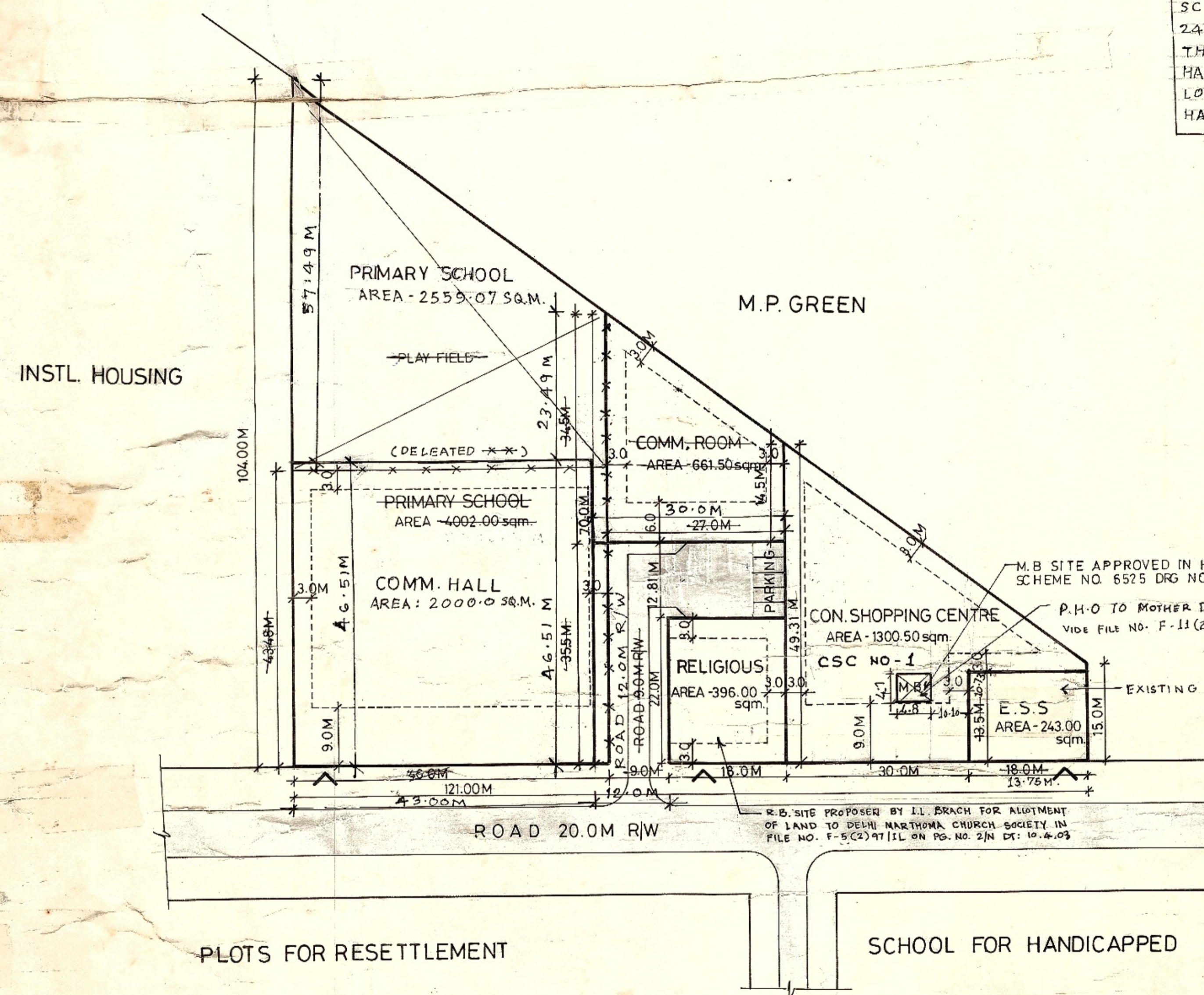

KEY PLAN

AREA STATEMENT :

Total area of the plot	7199.50 sqm.
- PRIMARY SCHOOL	2559.07
- CON. SHOPPING CENTRE	1300.50
- COMMUNITY ROOM	661.50
- RELIGIOUS	396.00
- E.S.S.	243.00
- CIRCULATION	700.93
- COMM. HALL	2000.00
TOTAL	7199.50 sqm.

NOTE: APPROVED IN 129th SCREENING COMMITTEE MEETING DATED 14.9.93. FEASIBILITY REPORT RECEIVED FROM XEN DATED 20.7.94 AND ACCORDINGLY PLAN GOT MODIFIED & APPROVED BY DTR (PLG) DWARKA IN FILE NO. F 8 (3) 94/SEC-3/HAF/23/DWK. DATED 29.9.94 AT PAGE 5/N.

1. THE ALLOTMENT POSITION IS AS PER REPORT FROM IL BRANCH IN F.No F23A(2)08/IL DATED : 12.09.2008.
2. THE LAND STATUS AND ALLOTMENT POSITION WILL BE RECHECKED FROM LD WING BEFORE ALLOTMENT.

- i) THE PLAN IS SUBJECT TO MODIFICATIONS WITHIN THE FRAMEWORK OF MASTER PLAN/ZONAL PLAN.
- ii) IT IS FOR PLANNING PURPOSE & IS NOT FIT TO BE PRODUCED IN THE COURT OF LAW FOR PROPERTY DISPUTES.
- iii) ALL THE DIMENSIONS & AREA GIVEN IN THE PLAN ARE SUBJECT TO CONFIRMATION OF OWNERSHIP/ALLOTMENT STATUS AND DEMARCATIONS/FEASIBILITY REPORT FROM THE DDA LANDS & ENGINEERING WING RESPECTIVELY.

SECTOR - 3
PKT A
MODIFIED PLAN
(DRAFT)

PROPOSED HOUSING AREA FACILITIES
Scale: 1:500
DWK/3(a)/HAF/93/09
DRG. NO.

S.P. VERMA PLG. D. MAN.	UMESH PLG. ASSTT.	SEPT. 94 DATE
T. SINGH ASSTT. DIRECTOR	ANIL BARAI JT. DIRECTOR	S. SRIVASTAVA DIRECTOR
DELHI DEVELOPMENT AUTHORITY		

DWARKA SUB-CITY (PAPANKALA)